



**BEDFORD**  
BOROUGH COUNCIL

**BEDFORD BOROUGH COUNCIL**

**(20MPH SPEED LIMIT) (THE CRESCENT AND WAVELL CLOSE,  
STEWARTBY, BEDFORD) ORDER 2018**

Bedford Borough Council, in exercise of its powers under Sections 82(2), 83(2), 84(1) and 84(2) of the Road Traffic Regulation Act 1984 ("the Act") and of all other enabling powers and after consultation with the Chief Officer of Police for Bedfordshire in accordance with Part III of Schedule 9 to the Act hereby makes the following Order:-

1. No person shall drive any motor vehicle at a speed exceeding 20 miles per hour on any length of road specified in the Schedule to this Order.
2. Nothing in Article 1 of this Order shall render it unlawful to cause or permit any vehicle to exceed the speed limit detailed within the Schedule to this Order for the provision to have effect as if no speed limit were imposed in relation to a vehicle used for emergency, naval, military or air force purposes while being driven by a person for the time being subject to the orders of a member of the armed forces or the Crown on an occasion when –
  - (a) the person driving the vehicle is a member of the special force;  
and
  - (b) the vehicle is being driven –
    - (i) in response, or for practice in responding, to a national security emergency by a person who has been trained in driving vehicles at high speeds; or
    - (ii) for the purpose of training a person in driving vehicles at high speeds
    - (iii) by an emergency response unit when used in connection on official duty which includes ambulance, fire and police services
3. This Order may be cited as the "Bedford Borough Council (20mph Speed Limit) (The Crescent and Wavell Close, Stewartby, Bedford) Order 2018" and shall come into operation on the 04<sup>th</sup> day of June 2018

THE COMMON SEAL of the  
BEDFORD BOROUGH COUNCIL  
was hereunto affixed this



24<sup>th</sup> day of June 2018

A handwritten signature in blue ink, appearing to read 'CAustin'.

Craig Austin  
Director of Environment

A handwritten signature in black ink, appearing to read 'Barbara H. Morris'.

Barbara H. Morris  
Assistant Chief Executive Law & Governance  
Solicitor to the Council

*Authorised officer*

**SCHEDULE**  
**In the Village of Stewartby**  
**Roads to which a 20mph speed limit shall apply.**

|              |  |
|--------------|--|
| The Crescent | The entire length of road  |
| Wavell Close | The entire length of road between Stewartby Way and The Crescent |

| AUTHORITY FOR EXECUTION   |                                |          |
|---------------------------|--------------------------------|----------|
| COUNCIL/COMMITTEE         | MINUTE No.                     | DATE     |
| DELEGATED POWER           | By whom executed<br><b>DOE</b> | DATE     |
|                           | OFFICERS INITIALS              | DATE     |
| ORIGINATED AND CHECKED BY | <b>JS</b>                      | 23.05.18 |
| APPROVED BY               | <b>AP</b>                      | 23.05.18 |



**BEDFORD**  
BOROUGH COUNCIL

## **STATEMENT OF REASONS**

**Bedford Borough Council (20mph Speed Limit) (The Crescent and Wavell Close, Stewartby, Bedford) Order 2018**

The proposal is part of the Borough Wide initiative to introduce lower speed limits in and around residential areas, and is response to a request received from the local Ward Councillor to introduce a 20mph Speed Limit Zone in The Crescent, Stewartby.

The proposal is aimed to reduce vehicle speeds in a residential area and near to a school. The proposal is aimed to improve road safety.

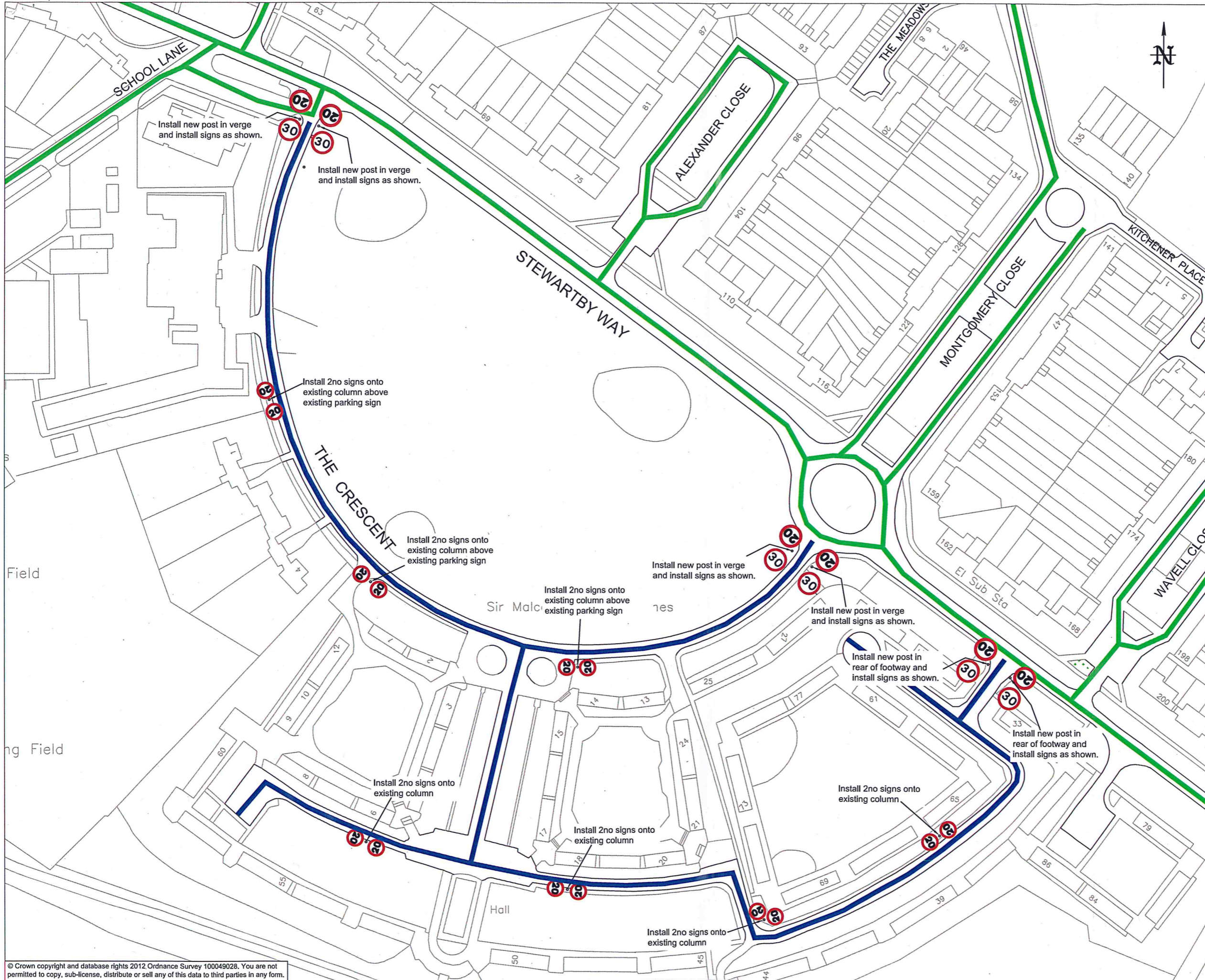

**KEY**

 Proposed speed limit change from 30mph to 20mph

 Existing 30mph speed limit to remain



© Crown copyright and database rights 2012 Ordnance Survey 100049028. You are not permitted to copy, sub-license, distribute or sell any of this data to third parties in any form.

|   |             |       |         |
|---|-------------|-------|---------|
| xx  | First Issue | 0     | xx      |
| DATE  | AMENDMENTS  | REV   | BY      |
|  <b>BEDFORD</b><br>BOROUGH COUNCIL |             |       |         |
| <b>Highways</b><br>BOROUGH HALL, CAULDWELL ST, BEDFORD, MK42 9AP<br>Tel. (01234) 278213                                 |             |       |         |
| CLIENT<br><b>Highways and Transport</b>   |             |       |         |
| SCHEME<br><b>The Crescent / Wavell Close Stewartby</b>  |             |       |         |
| DRAWING TITLE<br><b>Proposed 20mph speed limit Site 172</b>   |             |       |         |
| DRG No.<br><b>SP172</b>   |             |       |         |
| DRG STATUS<br><b>Consultation</b>   |             |       |         |
| SCALE @ A2  | DATE        | DRAWN | CHECKED |
| NTS   | Feb 18      | JS    |         |