



BEDFORD BOROUGH COUNCIL

BEDFORD BOROUGH COUNCIL

(BEDFORD URBAN AREA (SOUTH OF THE RIVER AND QUEENS PARK))

(PROHIBITION AND RESTRICTION OF WAITING AND LOADING AND PARKING PLACES) ORDER 2009 (AMENDMENT NO.35) ORDER 2018

BEDFORD BOROUGH COUNCIL in exercise of the powers under Section 1(1), 2(1), to (3) and 4(2) and Part IV of Schedule 9 of the Road Traffic Regulation Act 1984 ("The Act") and all other enabling powers and after consultation with the Chief Officer of Police in accordance with Part III of Schedule 9 to the Act, hereby makes the following Order:

1. This Order shall come into operation on the 17th December 2018 and may be cited as "Bedford Borough Council (Bedford Urban Area (South of the River and Queens Park)) (Prohibition and Restriction of Waiting and Loading and Parking Places) Order 2009 (Amendment No.35) Order 2018"
2. As from the date upon which the Order comes into operation, the provisions of the "Bedford Borough Council (Bedford Urban Area (South of the River and Queens Park)) (Prohibition and Restriction of Waiting and Loading and Parking Places) Order 2009 as amended" shall be varied as follows:
 - (i) The plan schedule reference "Grid Reference G29 Revision 3" shall be deleted and the plan schedule reference "Grid Reference G29 Revision 4" shall be inserted
 - (ii) The plan schedule reference "Grid Reference G30 Revision 1" shall be deleted and the plan schedule reference "Grid Reference G30 Revision 2" shall be inserted
 - (iii) The plan schedule reference "Grid Reference H29 Revision 4" shall be deleted and the plan schedule reference "Grid Reference H29 Revision 5" shall be inserted
 - (iv) The plan schedule reference "Grid Reference H30 Revision 5" shall be deleted and the plan schedule reference "Grid Reference H30 Revision 6" shall be inserted

**THE COMMON SEAL of the
BEDFORD BOROUGH COUNCIL**
Was hereunto affixed this



13th day of December 2018

In the presence of:

Handwritten signature of Barbara H. Morris in black ink.

Barbara H. Morris
Assistant Chief Executive Law & Governance
Solicitor to the Council

AUTHORITY FOR EXECUTION		
COUNCIL/COMMITTEE	MINUTE No.	DATE
DELEGATED POWER	By whom executed ENVIRONMENT	DATE 13.12.18
	OFFICERS INITIALS	DATE
ORIGINATED AND CHECKED BY	JS	13.12.18
APPROVED BY	AP	13.12.18

STATEMENT OF REASONS

The proposals are mainly at the request of the elected Ward Councillors. Concerns have been raised of inconsiderate parking at various locations within Queens Park. The proposals aim to address the concerns, improve the movement of traffic and generally improve road safety at these locations.



[Handwritten signature]

Driveway

62

50

2

16m

15m

OLD FORD END ROAD

10m

75

204
206

69

Utility box

HONEY HILL ROAD

143

20
19

xx	First Issue	0	xx
DATE	AMENDMENTS	REV	BY



Highways Department
BOROUGH HALL, CAULDWELL ST, BEDFORD, MK42 9AP
Tel. (01234) 276213

CLIENT
Environment and Sustainable Communities

SCHEME
Honey Hill Road jc
Old Ford End Road, Bedford

DRAWING TITLE
Proposed Yellow lines

DRG No.
C9001.C557

DRG STATUS
Consultation

SCALE @ A3	DATE	DRAWN	CHECKED
NTS	05 18	AK	JS

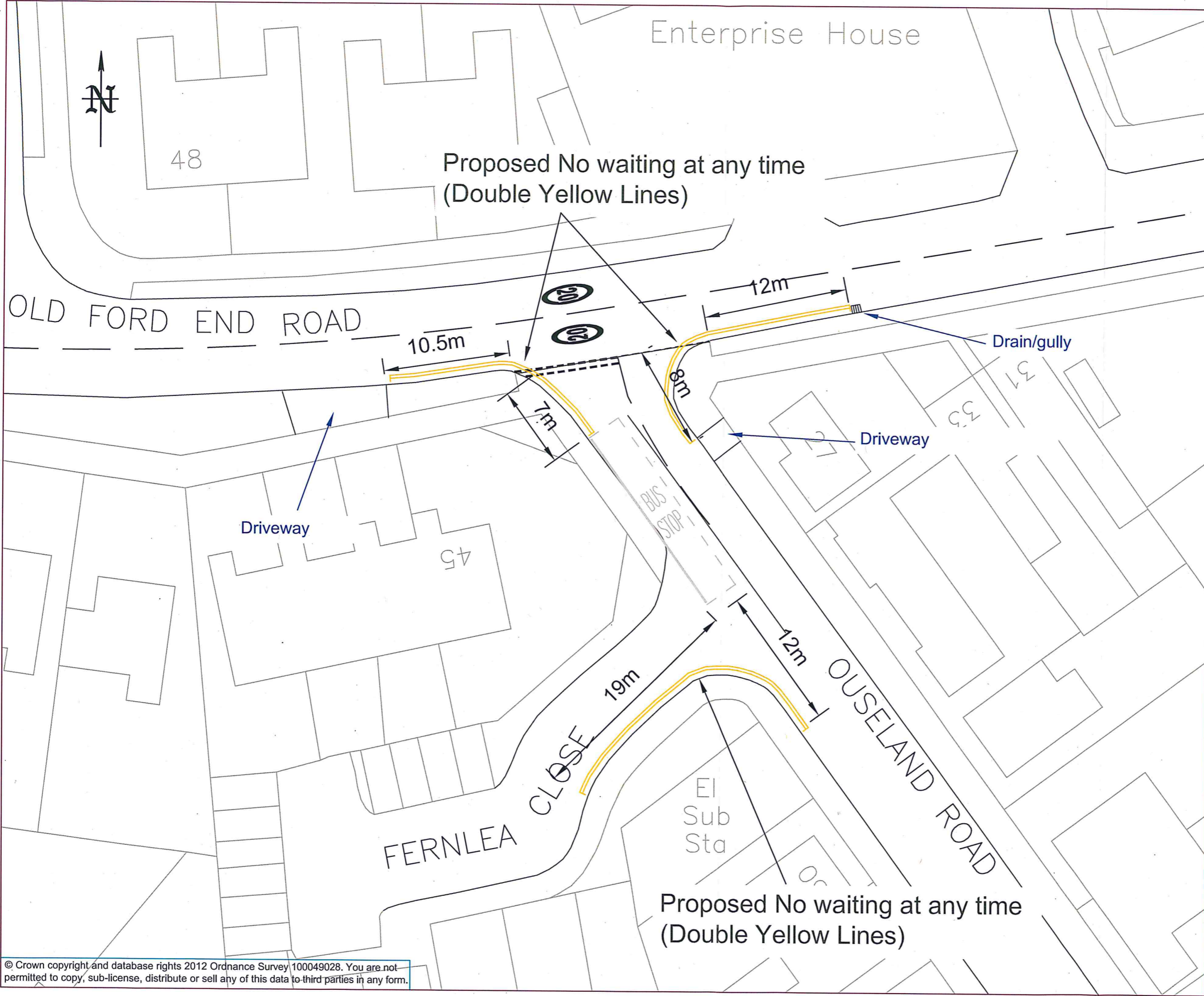

[Handwritten signature]

xx	First Issue	0	xx
DATE	AMENDMENTS	REV	BY

C:\Dwg logo\BBC logo.jpg

Highways Department
 BOROUGH HALL, CAULDWELL ST, BEDFORD, MK42 9AP
 Tel. (01234) 276213

CLIENT
Environment and Sustainable Communities

SCHEME
Fernlea Road, Ouselands Road & Ford End Road, Bedford

DRAWING TITLE
Proposed No waiting at any time (Double Yellow Lines)

DRG No.
C9001.C605

DRG STATUS
Consultation

SCALE @ A3	DATE	DRAWN	CHECKED
NTS	07 18	AK	JS



11/05/2018	First Issue	0	AK
DATE	AMENDMENTS	REV	BY



Highways Services
 BOROUGH HALL, CAULDWELL ST, BEDFORD, MK42 9AP
 Tel. (01234) 276213

CLIENT
Highways and Transport

SCHEME
 Queens Park Ward
Proposed Restrictions

DRAWING TITLE
 Ford End Road
 Woodstock Road

DRG No.
C9001.C551

DRG STATUS
Information

SCALE @ A4	DATE	DRAWN	CHECKED
NTS	01/05/18	AK	JS

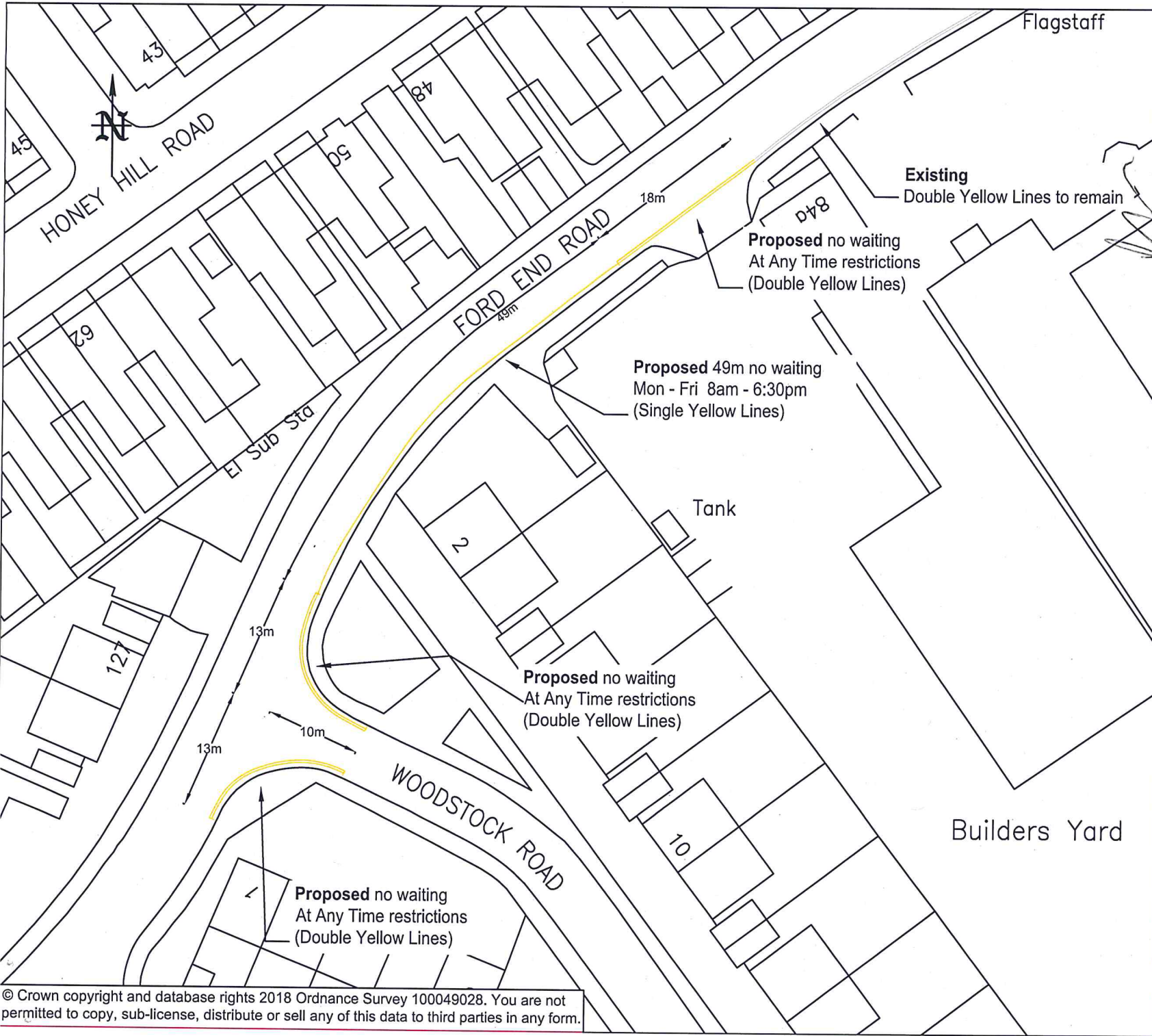

© Crown copyright and database rights 2018 Ordnance Survey 100049028. You are not permitted to copy, sub-license, distribute or sell any of this data to third parties in any form.

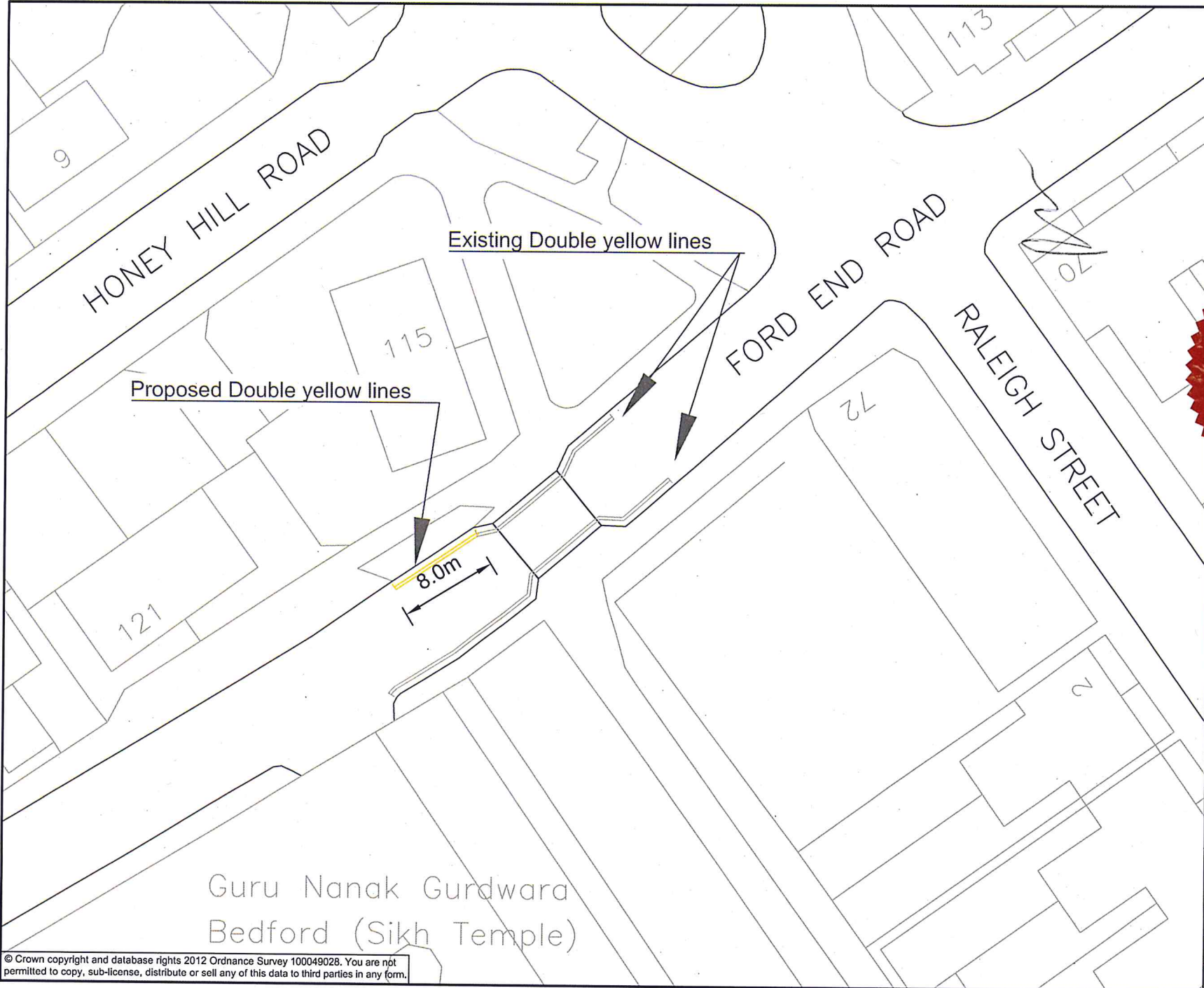

Guru Nanak Gurdwara
Bedford (Sikh Temple)

XX	First Issue	0	XX
DATE	AMENDMENTS	REV	BY



Highways Department
BOROUGH HALL, CAULDWELL ST, BEDFORD, MK42 9AP
Tel. (01234) 276213

CLIENT
Environment and Sustainable Communities

SCHEME
Ford End Road Bedford

DRAWING TITLE
Proposed Double Yellow Lines
Guru Nanak Gurdwara

DRG No.
C9001.C558
DRG STATUS
Consultation

SCALE @ A3	DATE	DRAWN	CHECKED
NTS	05 18	AK	JS



Handwritten signature or initials.

XX	First Issue	0	XX
DATE	AMENDMENTS	REV	BY



Highways Department
 BOROUGH HALL, CAULDWELL ST, BEDFORD, MK42 9AP
 Tel. (01234) 276213

CLIENT
Environment and Sustainable Communities

SCHEME
Ford End Road Bedford

DRAWING TITLE
Proposed Double Yellow Lines Old Ford End Roundabout

DRG No.
C9001.C614

DRG STATUS
Consultation

SCALE @ A3	DATE	DRAWN	CHECKED
NTS	06 18	AK	JS

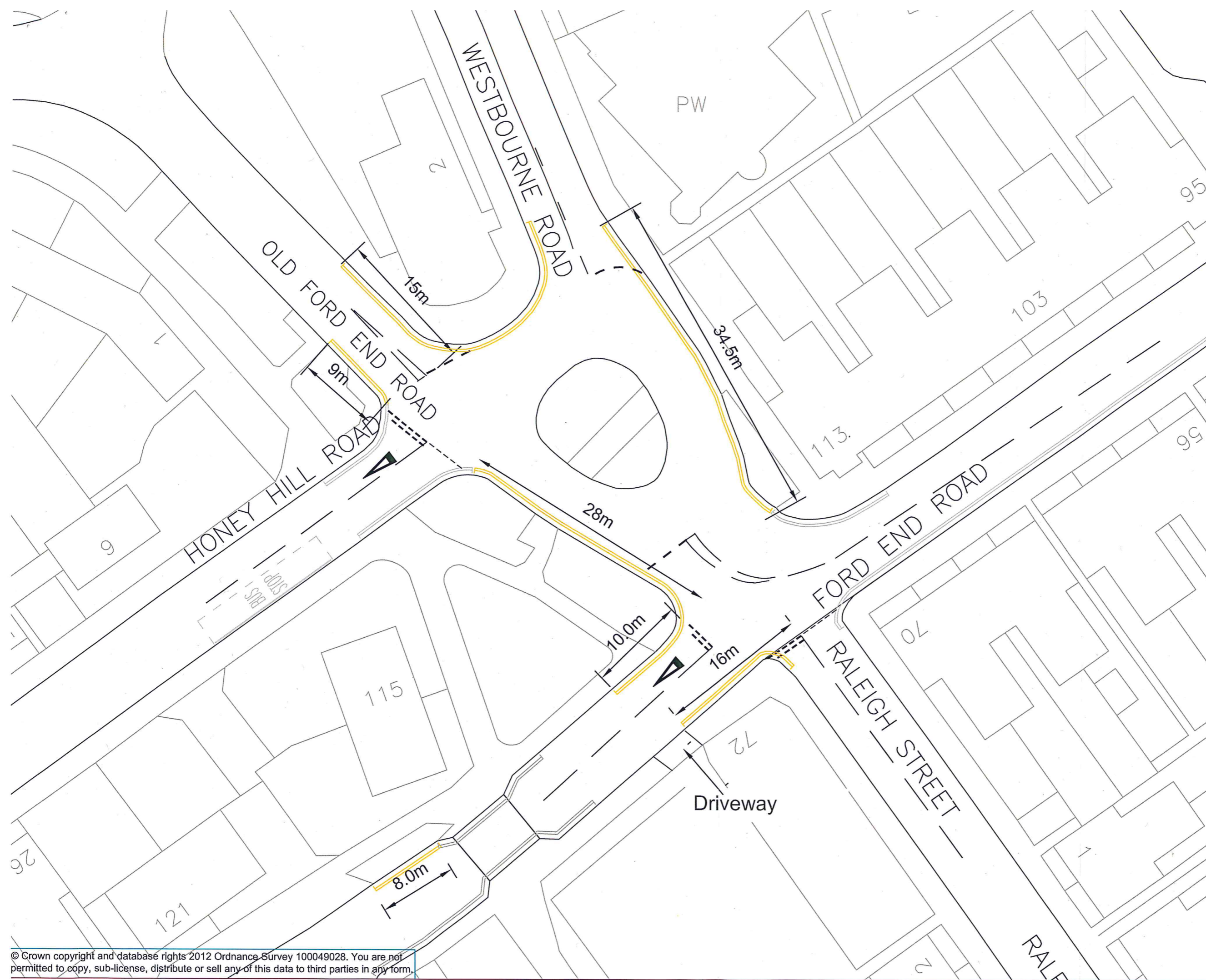

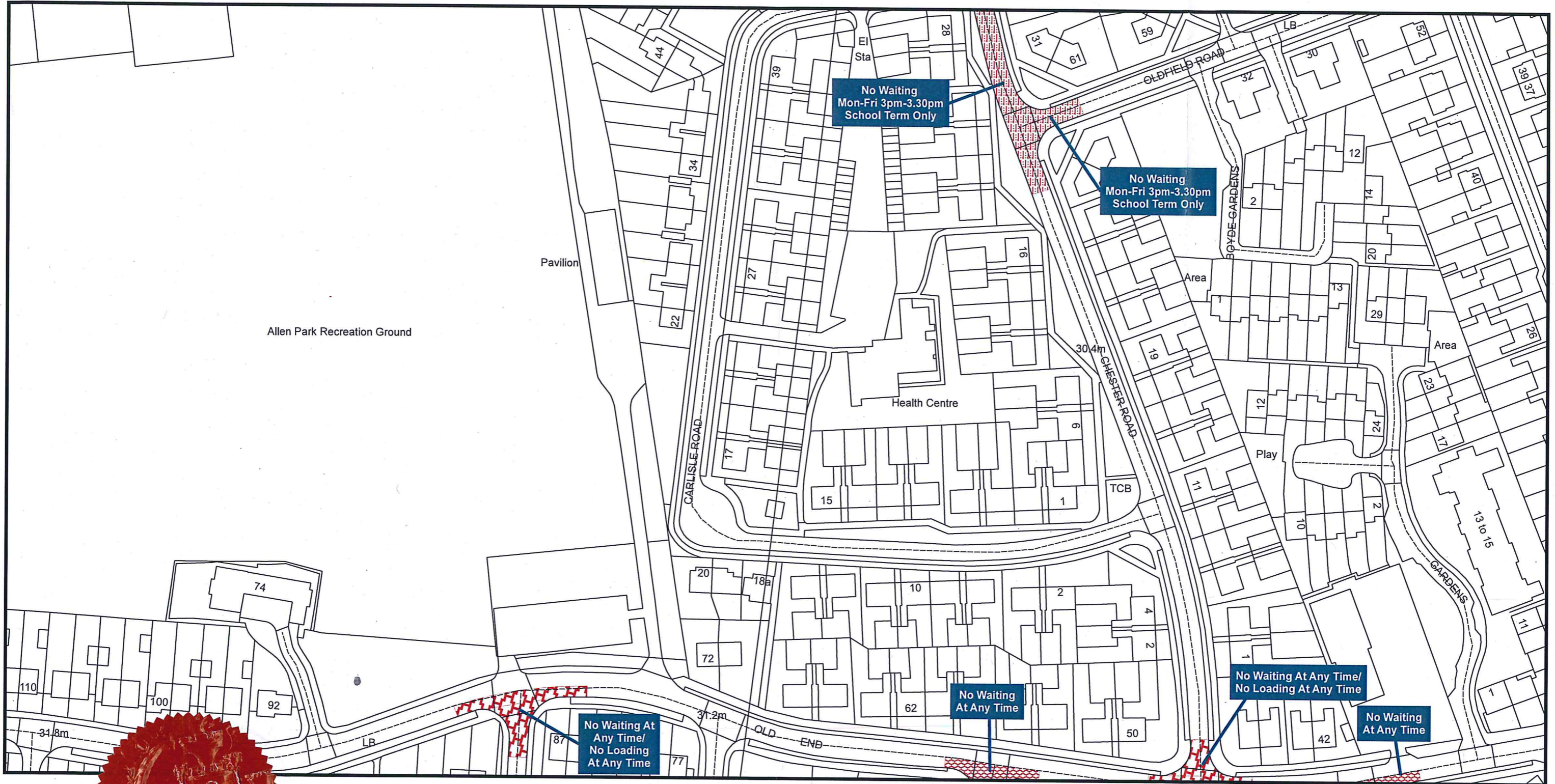

Bedford Borough Council (Bedford Urban Area (South of the River and Queens Park)) (Prohibition and Restriction of Waiting and Loading and Parking Places) Order 2009

Bedford Borough Council
Borough Hall
Cauldwell Street
Bedford MK42 9AP

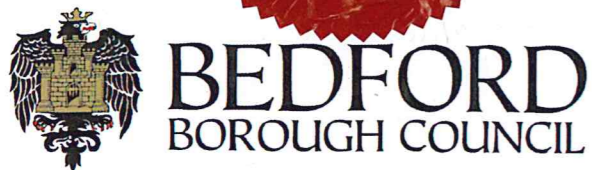

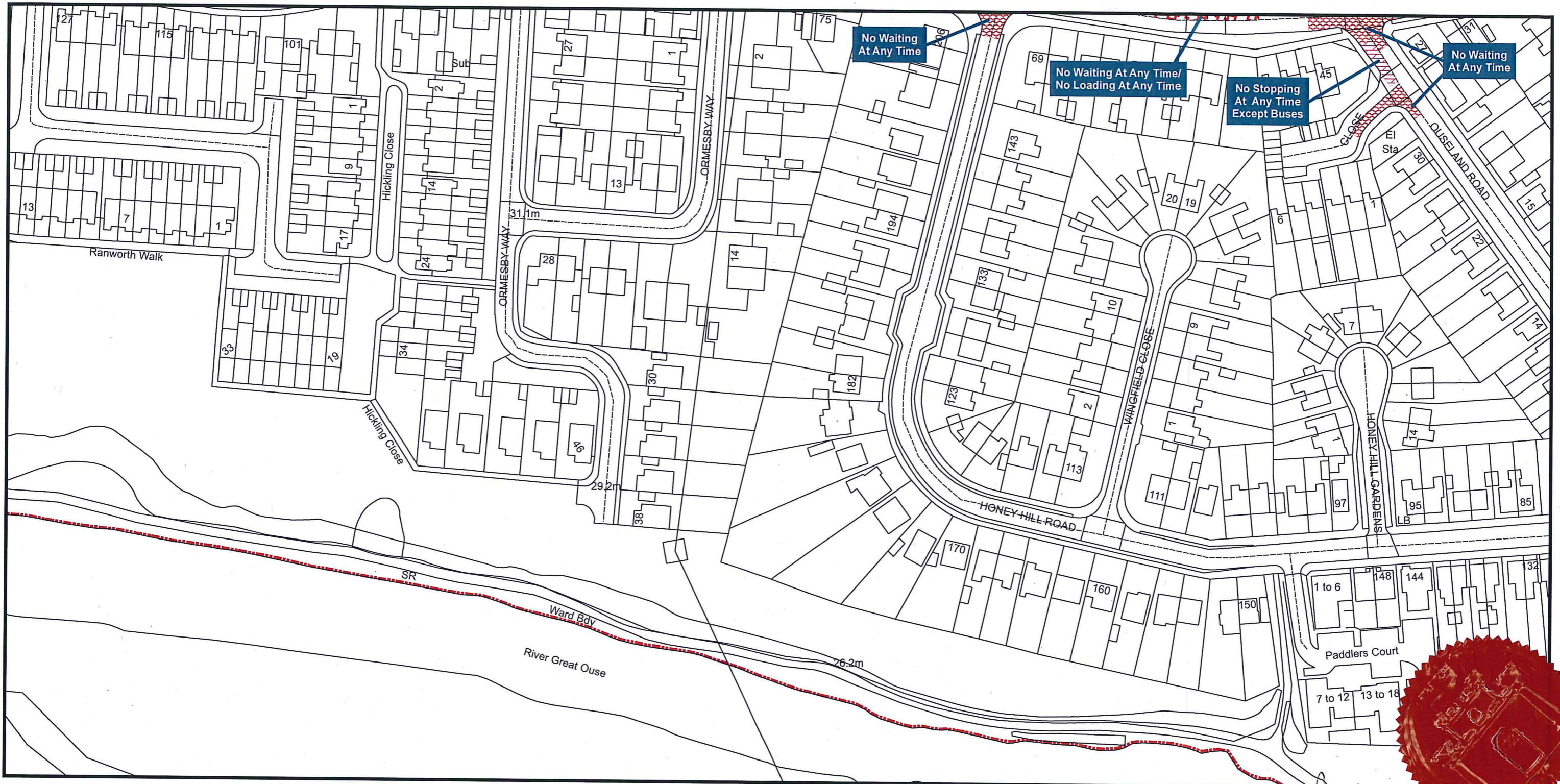

Bedford Borough Council (Bedford Urban Area (South of the River and Queens Park)) (Prohibition and Restriction of Waiting and Loading and Parking Places) Order 2009

Bedford Borough Council
Borough Hall
Cauldwell Street
Bedford MK42 9AP



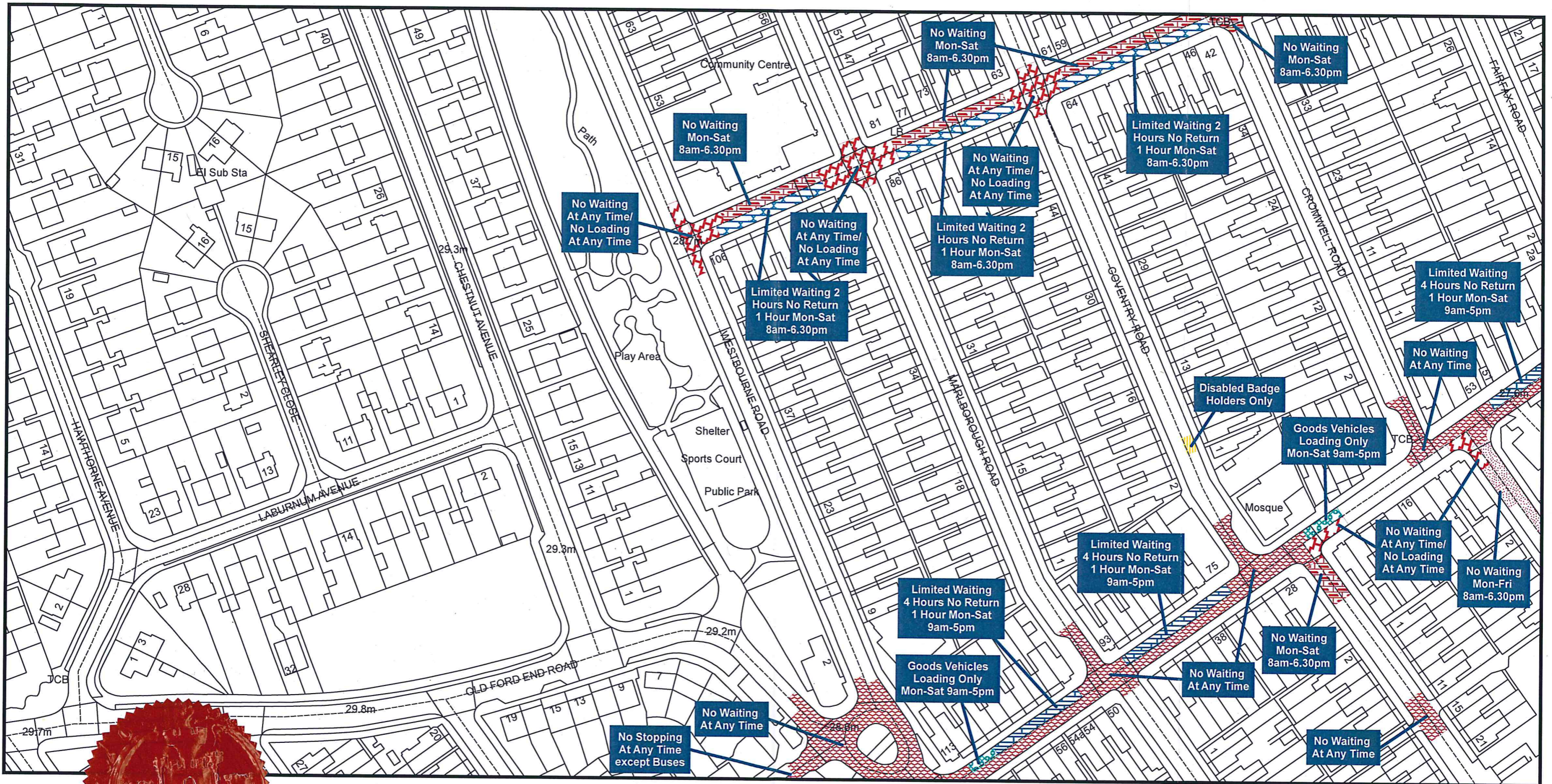

Bedford Borough Council (Bedford Urban Area (South of the River and Queens Park)) (Prohibition and Restriction of Waiting and Loading and Parking Places) Order 2009

Bedford Borough Council
 Borough Hall
 Cauldwell Street
 Bedford MK42 9AP



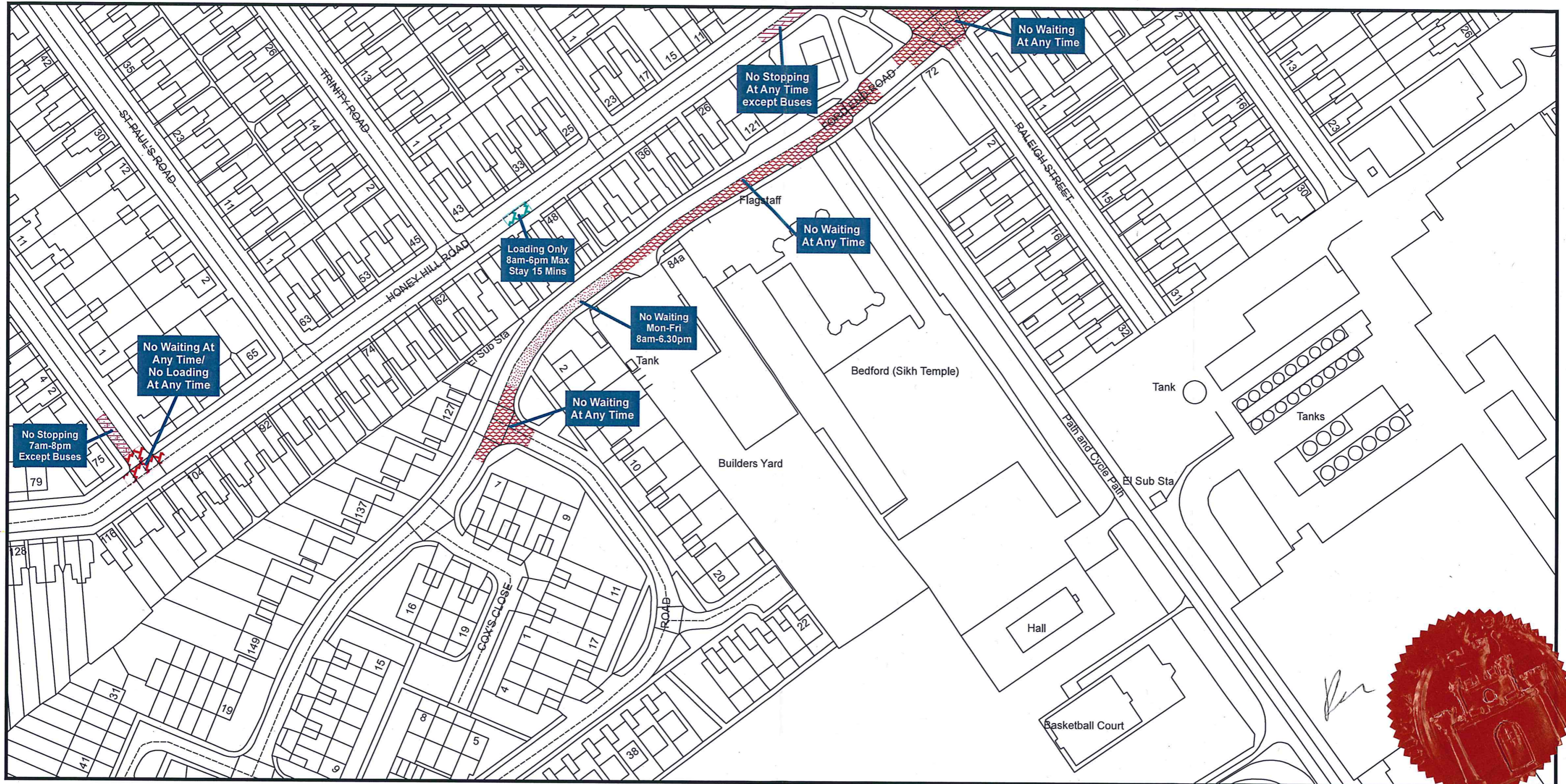

Bedford Borough Council (Bedford Urban Area (South of the River and Queens Park)) (Prohibition and Restriction of Waiting and Loading and Parking Places) Order 2009

Bedford Borough Council
 Borough Hall
 Cauldwell Street
 Bedford MK42 9AP

