



BEDFORD
BOROUGH COUNCIL

BEDFORD BOROUGH COUNCIL
(BEDFORD URBAN AREA (NORTH OF THE RIVER EXCLUDING QUEENS PARK
AND CPZ AREAS)) (PROHIBITION AND RESTRICTION OF WAITING AND
LOADING AND PARKING PLACES) ORDER 2009
(AMENDMENT NO.72) ORDER 2021

BEDFORD BOROUGH COUNCIL ("the Council") in exercise of the powers conferred by Sections 1(1), 2(1) to (3) and 4(2) of, and Part IV of Schedule 9 to, the Road Traffic Regulation Act 1984 as amended ("the Act") and of all other powers enabling them in that behalf, and after consultation with the Chief Officer of Police in accordance with Part III of Schedule 9 to the Act, hereby make the following Order:-

1. This Order may be cited as the "Bedford Borough Council (Bedford Urban Area (North of the River Excluding Queens Park and CPZ Areas)) (Prohibition and Restriction of Waiting and Loading and Parking Places) Order 2009 (Amendment No.72) Order 2021" and shall come into force on 15th October 2021.
2. As from the date upon which this Order comes into force the provisions of the Bedford Borough Council (Bedford Urban Area (North of the River Excluding Queens Park and CPZ Areas)) (Prohibition and Restriction of Waiting and Loading and Parking Places) Order 2009 as amended shall be varied as follows:
 - (i) The plan schedule reference "Grid Ref: P 24 Revision No: 2" shall be deleted and the plan schedule reference "Grid Ref: P 24 Revision No: 3" shall be inserted.
 - (ii) The plan schedule reference "Grid Ref: P 25 Revision No: 3" shall be deleted and the plan schedule reference "Grid Ref: P 25 Revision No: 4" shall be inserted
3. This Amendment shall be read and construed as one with the Bedford Borough Council (Bedford Urban Area (North of the River Excluding Queens

Park and CPZ Areas)) (Prohibition and Restriction of Waiting and Loading and Parking Places) Order 2009 as amended.

**THE COMMON SEAL of the
BEDFORD BOROUGH COUNCIL**

was hereunto affixed this

7th day of October 2021

in the presence of:



A handwritten signature in blue ink, appearing to read 'David Doorne'.

Authorised Signatory

DAVID DOORNE
Team Leader (GPP&L)
(Solicitor)

AUTHORITY FOR EXECUTION		
COUNCIL/COMMITTEE	MINUTE No.	DATE
DELEGATED POWER	By whom executed ENVIRONMENT	06/10/2021
	OFFICERS INITIALS	DATE
ORIGINATED AND CHECKED BY	JH	06/10/2021
APPROVED BY	AP	06/10/2021



BEDFORD
BOROUGH COUNCIL

BEDFORD BOROUGH COUNCIL
(BEDFORD URBAN AREA (NORTH OF THE RIVER EXCLUDING QUEENS PARK
AND CPZ AREAS)) (PROHIBITION AND RESTRICTION OF WAITING AND
LOADING AND PARKING PLACES) ORDER 2009
(AMENDMENT NO.72) ORDER 2021

STATEMENT OF REASONS

Bedford Borough Council has received a request for parking restrictions in Chapel Close, Bedford because of concerns raised about inconsiderate parking which is affecting visibility and safety.

This is especially so when the nearby school begins and finishes each day, so these proposals are intended to help resolve these issues.



GOLDINGTON ROAD

16m

CHapel CLOSE

Double yellow lines for 49 metres

NSP

Double yellow lines/
single yellow line
changeover point.

S2

Proposed sign to S2 to be
installed on new 76mm
sign post.

S1

Proposed signs to S1 to
be installed on existing
lamp columns.

S1

Single yellow line for 125 metres

CHapel CLOSE

S1

Proposed Signage



S1 x 3







S2 x 1

PRINTS FROM THIS DRAWING ARE UNCONTROLLED UNLESS OTHERWISE STATED

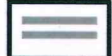
A3

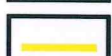
KEY:

-  Existing lamp column
-  Existing road markings
-  Existing gully
-  Proposed double yellow lines to TSRGD 1018.1
-  Proposed single yellow line to TSRGD 1017.1
-  New 76mm diameter sign post.

Dee



Terminal point of
proposed single yellow
line at existing gully.

01/09/2021	First Issue	0	JH
DATE	AMENDMENTS	REV	BY



Traffic Management
BOROUGH HALL, CAULDWELL ST, BEDFORD, MK42 9AP
Tel. (01234) 267422

CLIENT
Environment

SCHEME
**Chapel Close,
Bedford**

DRAWING TITLE
**Proposed Parking Restrictions
(Double Yellow Lines, Single
Yellow Line and Signs)**

DRG No.
CO16-CC-NW-DSYL-PROP
DRG STATUS
Consultation

SCALE @ A3	DATE	DRAWN	CHECKED
NTS	01/09/2021	JH	AP

Proposed Layout

© Crown copyright and database rights 2021 Ordnance Survey 100049028. You are not permitted to copy, sub-license, distribute or sell any of this data to third parties in any form.

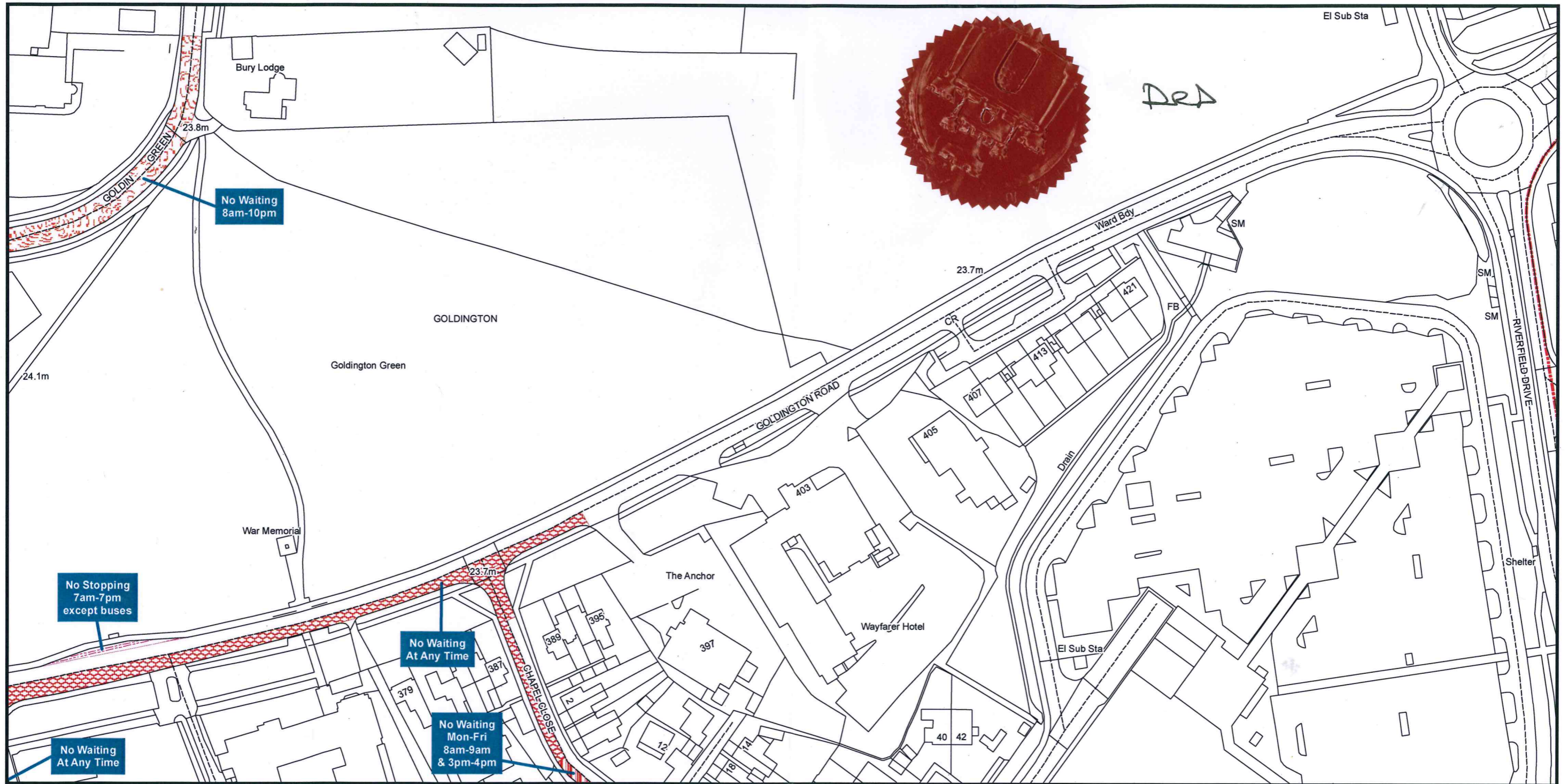

Bedford Borough Council (Bedford Urban Area (North of the River excluding Queens Park and CPZ areas)) (Prohibition and Restriction of Waiting and Loading and Parking Places) Order 2009



Bedford Borough Council
Borough Hall
Cauldwell Street
Bedford MK42 9AP



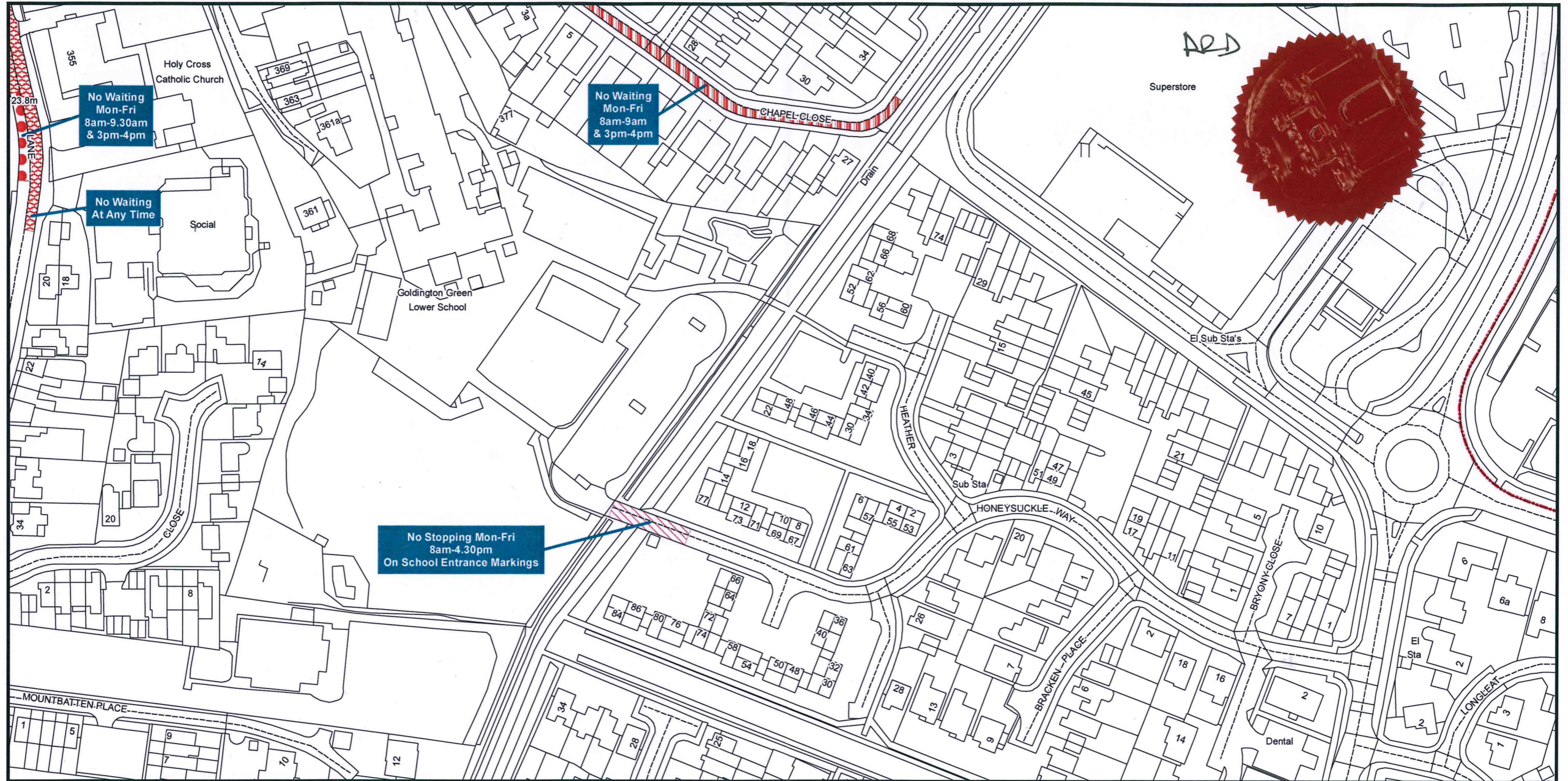

Bedford Borough Council (Bedford Urban Area (North of the River excluding Queens Park and CPZ areas)) (Prohibition and Restriction of Waiting and Loading and Parking Places) Order 2009



Bedford Borough Council
Borough Hall
Cauldwell Street
Bedford MK42 9AP

