



**BEDFORD BOROUGH COUNCIL
(BUS LANES AND BUS ONLY STREETS,
THE BOROUGH OF BEDFORD) CONSOLIDATION ORDER 2014
(AMENDMENT NO. 1) ORDER 2015**

Bedford Borough Council (the "Council") in exercise of the powers under sections 1(1) and (2), 2(1) and (2) and 4(1) of the Road Traffic Regulation Act 1984 ("The Act") and all other enabling powers and after consultation with the Chief Officer of Police in accordance with Part III of schedule 9 to the Act, hereby makes the following Order:-

1. This Order shall come into operation on the 05th day of October 2015 and may be cited as the "Bedford Borough Council (Bus Lanes and Bus Only Streets, The Borough of Bedford) Consolidation Order 2014 (Amendment No.1) Order 2015".
2. From the date this Order comes into effect, the "Bedford Borough Council (Bus Lanes and Bus Only Streets, The Borough of Bedford) Consolidation Order 2014" shall take the following effect:

3. **Article 14**

Remove

Save as provided in Article 16 to this Order, no person shall cause or permit any mechanically propelled vehicle to be in the length of road specified in Schedule 2 to this Order and shown as restricted on the Plans to this Order during the its restricted hours.

And in its place Insert

Save as provided within Article 16 and specifically defined within Schedule 2 to this Order, no person shall cause or permit any vehicle to be in the length of road specified in Schedule 2 to this Order and shown as restricted on the Plans to this Order during the its restricted hours

4. **Schedule 2 – Identification of street forming a Bus Only Street**

Remove the existing Schedule 2 and

Insert with Schedule 2 as shown below.

Schedule 2 – Identification of streets forming a Bus Only Street

| Road name/Town | Class of vehicles permitted to use Bus Lane | Operational hours of restriction | Extent of restriction as shown on the Plans |
|---|--|----------------------------------|---|
| Bedford Road, Wixams, | <i>Refer to Article 16 (All)</i> | At all times | K44, K45 |
| Greenkeepers Road, Great Denham | <i>Refer to Article 16 (All)</i> | At all times | F29, F30 |
| The Highway, Shortstown | <i>Refer to Article 16 (All)</i> | At all times | P39 |
| Greyfriars (Bus Station Forecourt), Bedford | <i>Refer to Article 16 (Items a,b,c &f only)</i> | At all times | J27 |

5. As from the date upon which this Order comes into operation, the provision of the "Bedford Borough Council (Bus Lanes and Bus Only Streets, The Borough of Bedford) Consolidation Order 2014" shall be varied as follows:

- (i) The plan schedule reference "Grid Reference J27 Revision No 0" shall be deleted and "Grid Reference J27 Revision No 1" shall be substituted

This Amendment shall be read and construed as one with "Bedford Borough Council (Bus Lanes and Bus Only Streets, The Borough of Bedford) Consolidation Order 2014"

THE COMMON SEAL of the
BEDFORD BOROUGH COUNCIL
was hereunto affixed this

01st day of October 2015



Executive Director for Environment and Sustainable Communities

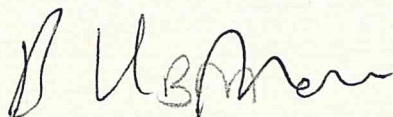

Assistant Chief Executive (Governance & Human Resources) and Solicitor to the Council

| AUTHORITY FOR EXECUTION | | |
|---------------------------|----------------------------------|----------|
| COUNCIL/COMMITTEE | MINUTE No. | DATE |
| DELEGATED POWER | By whom executed EDESC | DATE |
| | OFFICERS INITIALS | DATE |
| ORIGINATED AND CHECKED BY | JS | 28/09/15 |
| APPROVED BY | <i>DT</i> | 29/09/15 |





BEDFORD BOROUGH COUNCIL

**BEDFORD BOROUGH COUNCIL
(BUS LANES AND BUS ONLY STREETS, THE BOROUGH OF BEDFORD)
CONSOLIDATION ORDER 2014 (AMENDMENT NO. 1) ORDER 2015**

STATEMENT OF REASONS

Bedford Borough Council has recently upgraded the bus station within the town centre as part of the town centre redevelopment and rejuvenation project. The bus station is now a dedicated area for buses only whereas previously it accommodated taxi's and disabled parking. It has been observed that non-permitted vehicles continue to use the bus station to drop off passengers. This is causing access problems for the buses, manoeuvring within the bus station forecourt and putting passengers at risk as they may be walking within areas only reserved for buses.

It is considered necessary to introduce a restriction to allow only buses to enter the bus station forecourt. As part of the restrictions, it is proposed that enforcement measures are put in place to ensure compliance of the restrictions (enforcement by Automatic Number Plate Recognition (ANPR)).

The bus station forecourt entry will be signed with the appropriate traffic signs which must be adhered to. Failure to comply with the conveyed restriction may result in a vehicle receiving a penalty charge notice.

The bus only signs are similar to other locations within the Borough. However, pedal and electrically assisted cycles will not be permitted into the bus station forecourt unless they are pushed by hand.

KEY

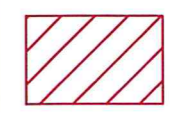

Extent of prohibition of vehicles except for buses restriction enforced by Automatic Number Plate Recognition Camera



| | | | |
|------|-------------|-----|----|
| xx | First Issue | 0 | xx |
| DATE | AMENDMENTS | REV | BY |



Highways Department
 BOROUGH HALL, CAULDWELL ST, BEDFORD, MK42 9AP
 Tel. (01234) 276213

CLIENT
Environment and Sustainable Communities

SCHEME
Bus Station Bedford

DRAWING TITLE
Proposed prohibition of vehicle except for buses only

DRG No.
C9001.C265

DRG STATUS
Consultation

| | | | |
|------------|---------|-------|---------|
| SCALE @ A3 | DATE | DRAWN | CHECKED |
| NTS | June 15 | JS | |

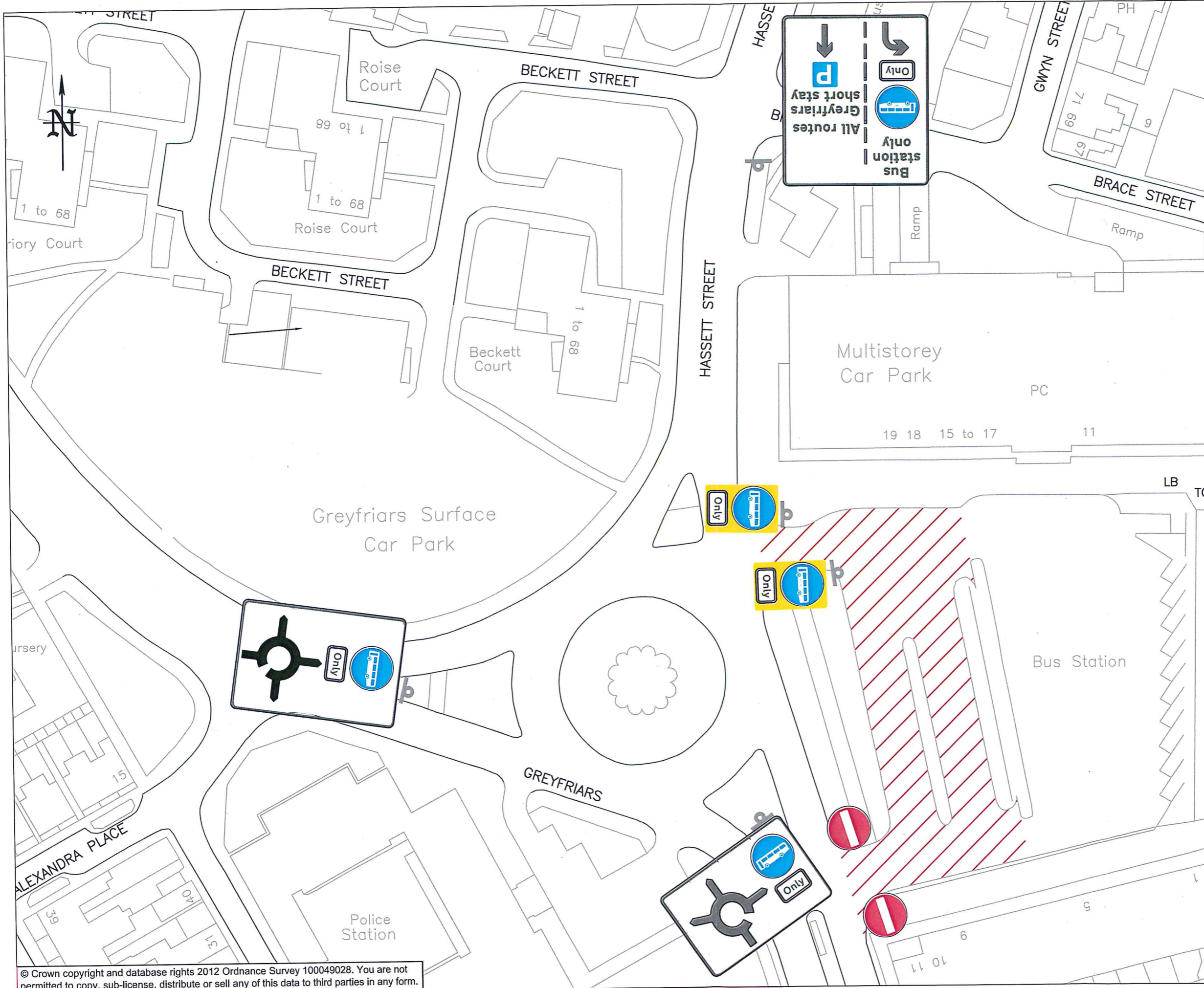

Grid Ref: J 27

Revision No: 1

Date:

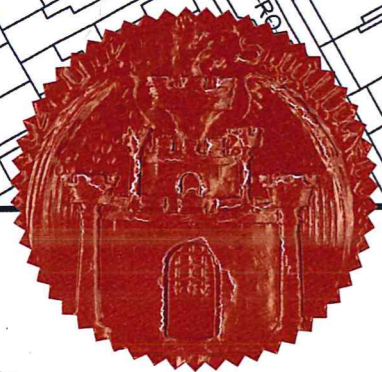
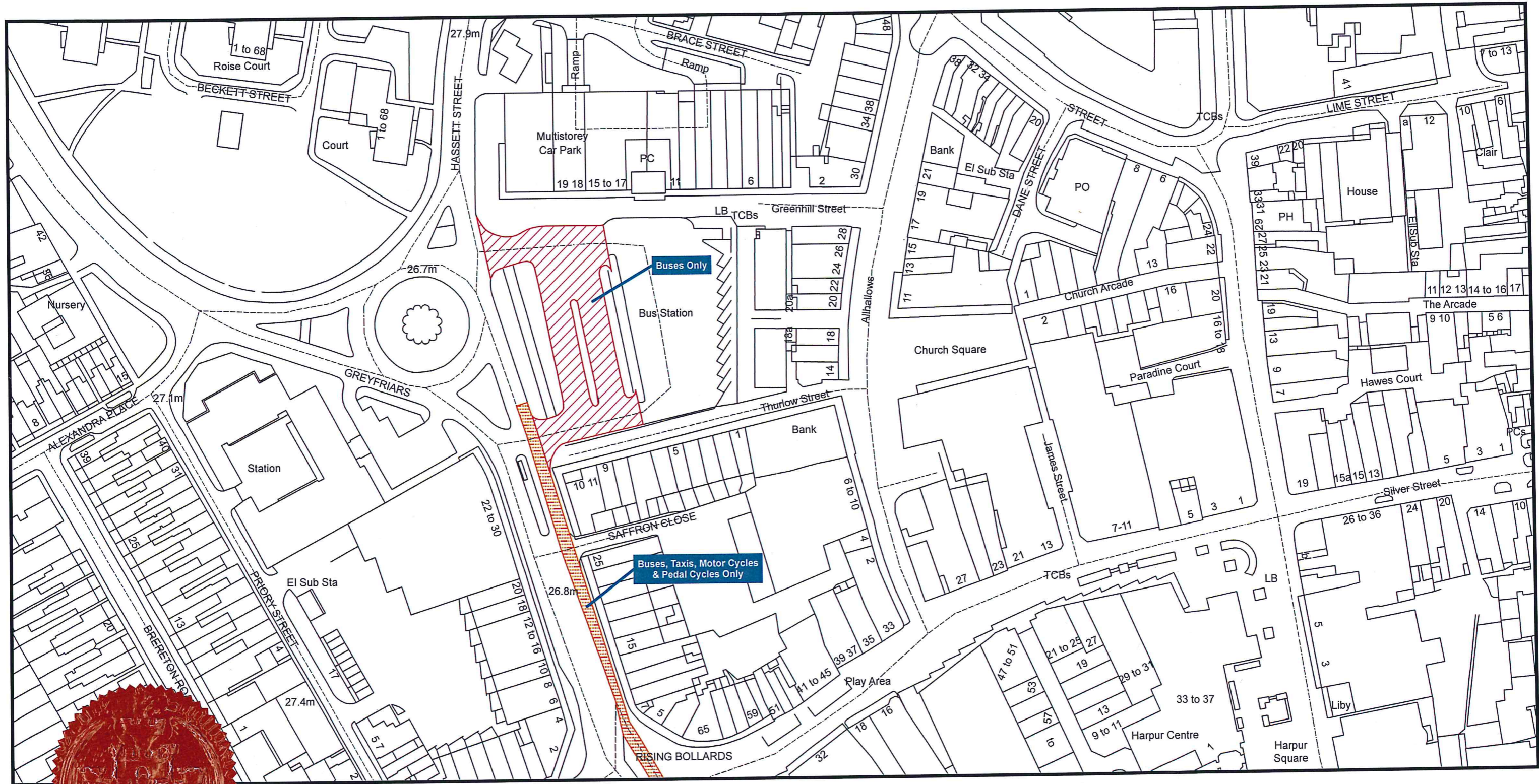

16m
3B

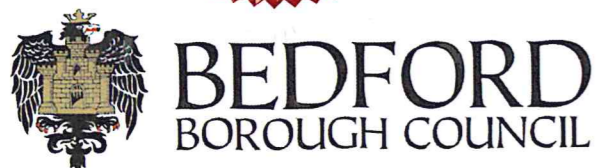

Bedford Borough Council (Bus Lanes and Bus Only Streets, The Borough of Bedford) Consolidation Order 2014

Bedford Borough Council
Borough Hall
Cauldwell Street
Bedford MK42 9AP

Reproduced from the Ordnance Survey map with the permission of Her Majesty's Stationary Office © Crown Copyright Licence No. LA077127 (2015). Unauthorised reproduction infringes Crown Copyright and may lead to prosecution or civil proceedings.

Scale - 1:1,250

