

CA16 Application Form

PART A

Information relating to the applicant and land to which the application relates
(all applicants must complete this Part)

1. Name of appropriate authority to which the application is addressed:

Bedford Borough Council

2. Name and full address (including postcode) of applicant:

Bedfordia Farms Limited of Milton House Farm, Milton Ernest, Bedfordshire MK44 1YU.

3. Status of applicant (tick relevant box or boxes):

I am making this application and the statements/declarations it contains on behalf of Bedfordia Farms Limited who is the owner of the land described in paragraph 4 and in my capacity as a director of Bedfordia Farms Limited

4. Insert description of the land(s) to which the application relates (including full address and postcode):

Land at Green End Road, Kempston

5. Ordnance Survey six-figure grid reference(s) of a point within the area of land(s) to which the application relates (if known):

TL 013473

6. This deposit comprises the following statement(s) and/or declarations (*delete Parts B, C, or D where not applicable*):

PART D

Statement under section 15A(1) of the Commons Act 2006

Bedfordia Farms Limited is the owner of the land described in paragraph 4 of Part A of this form and shown edged pink on the map accompanying this statement.

Bedfordia Farms Limited wish to bring to an end any period during which persons may have indulged as of right in lawful sports and pastimes on the whole or any part of the land shown edged pink on the accompanying map.

PART E

Additional information relevant to the application
(insert any additional information relevant to the application)

None.

PART F:

Statement of Truth
(all applicants must complete this Part)

WARNING: If you dishonestly enter information or make a statement that you know is, or might be, untrue or misleading, and intend by doing so to make a gain for yourself or another person, or to cause loss or the risk of loss to another person, you may commit the offence of fraud under section 1 of the Fraud Act 2006, the maximum penalty for which is 10 years' imprisonment or an unlimited fine, or both.

I BELIEVE THAT THE FACTS AND MATTERS CONTAINED IN THIS FORM ARE TRUE

Signature (of the person making the statement of truth):

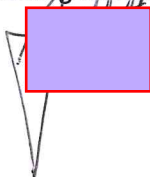

Print full name:

Date: 9 October 2014

You should keep a copy of the completed form

Data Protection Act 1998 - Fair Processing Notice

The purpose of this Fair Processing Notice is to inform you of the use that will be made of your personal data, as required by the Data Protection Act 1998.

The appropriate authority (see explanation of definition in above guidance notes) in England is the data controller in respect of any personal data that you provide when you complete this form.

The information that you provide will be used by the appropriate authority in its duties to process applications to deposit statements, maps and declarations under section 31(6) the Highways Act 1980 and statements under section 15A(1) of the Commons Act 2006. The information you provide will also be used by the appropriate authority in its duty to update the registers in which details of such deposits are recorded under the Dedicated Highways (Registers under Section 31A of the Highways Act 1980) (England) Regulations 2007 and the Commons (Registration of Town or Village Greens) and Dedicated Highways (Landowner Statements and Declarations) (England) Regulations 2013.

The appropriate authority is required by the legislation above to maintain a register which holds information provided in this form, which can be inspected online or in person by members of the public on request. It may also be required to release information, including personal data and commercial information, on request under the Environmental Information

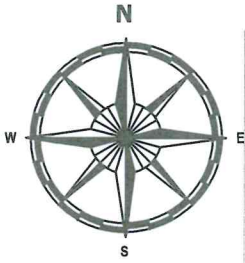

Based upon the Ordnance Survey
sheet No. TL 0147

With the Sanction of the Controller of H.M. Stationery Office.
Crown Copyright Reserved. Licence No. 100022265

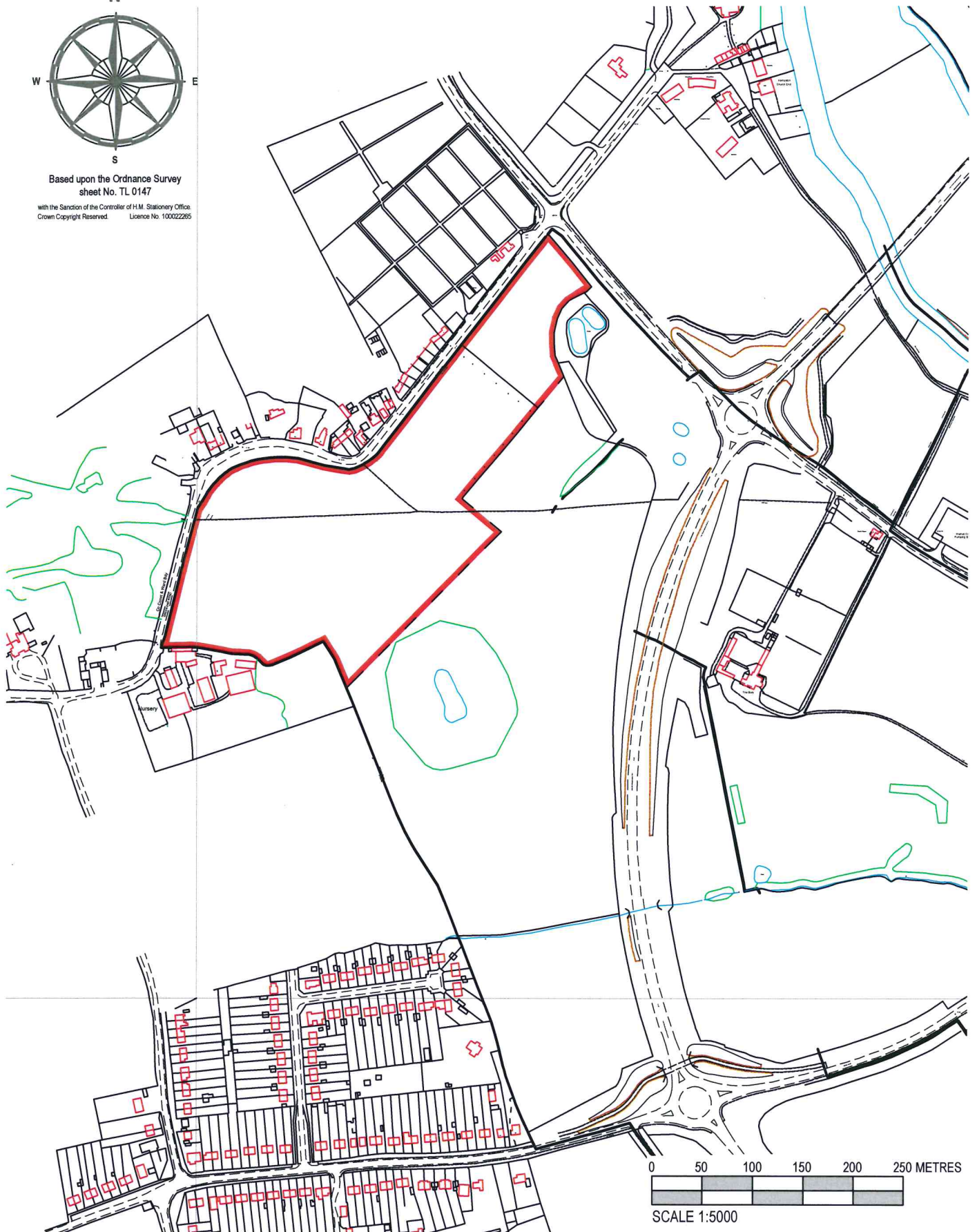

A4 | LOCATION PLAN

DRAWING | **A | 34961 | 38**

Project : **LAND AT GREEN END ROAD
KEMPSTON
BEDFORDSHIRE**

Date : **MAR. 2014**

**Land & Property
Consultants**

Bedford Buckingham
Ipswich Colchester
robinsonandhall.co.uk

